

Port-Plug Extractor – Instruction Sheet

316L Stainless Steel Port-Plug Extractor:

On the rare occasion that a plug or housing becomes stuck in a 25 mm threaded port, you can use the Port-Plug Extractor to remove the stuck hardware. The extractor may be used with both standard and B.Braun Biotech vessels and is made of 316L stainless steel. The port will need to be cleaned and polished afterward to make sure future plugs and housings don't get stuck.

The Right Tool For The Job

The Port-Plug Extractor allows a vessel operator to remove stuck hardware from a vessel port by applying force where it is most useful. If the port is slightly damaged or no longer perfectly round, the friction of metal against metal can cause the two stainless steel parts to become stuck together. Using this extractor to remove the plug or housing from the port will prevent further damage to the port.

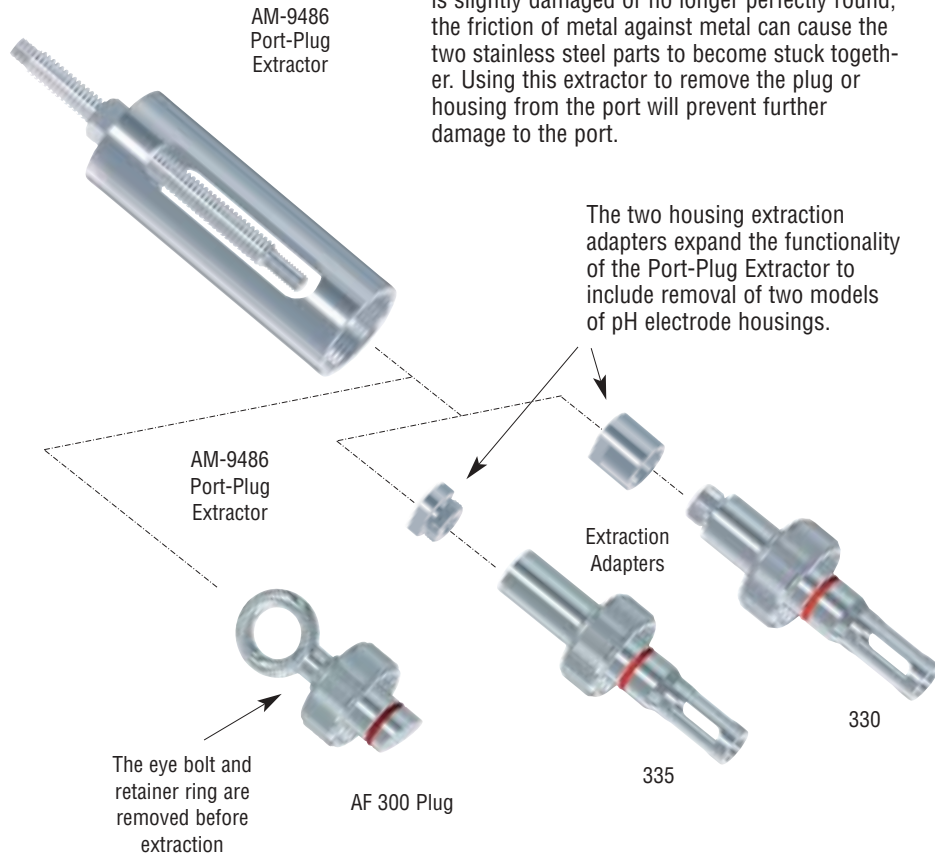

(Turn page over for step-by-step instructions)

Step 1

If the 25 mm threaded port plug is stuck in the 25 mm threaded port...

1. Unscrew the eye bolt from the plug body.
2. Unscrew the retainer ring from the port.

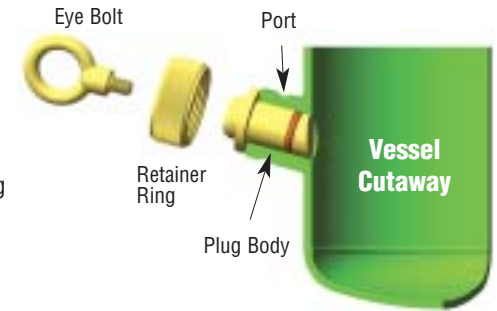

Step 2

Gather together all of the parts of the port-plug extractor, and a wrench...

1. Screw the body of the port-plug extractor onto the port.
2. Screw the jack screw of the port-plug extractor into the eye-bolt hole of the plug, using your fingers or a wrench.

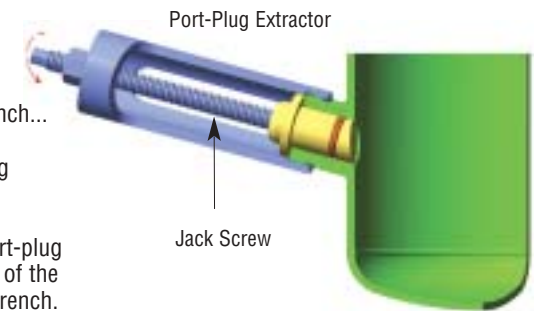

Step 3

1. Using a wrench, tighten the hex nut against the body of the extractor (while holding the end of the jack screw stationary) to pull the plug from the port.
2. When the plug is free from the port, unscrew the extractor from the threaded port.
3. The body of the plug can now be unscrewed from the port-plug extractor.

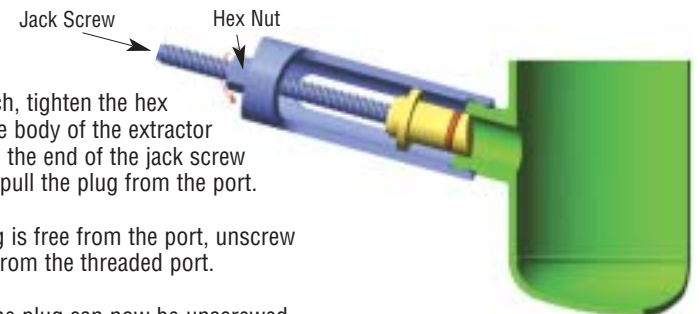

BROADLEY
TECHNOLOGIES

19 Thomas, Irvine, California 92618 USA
Toll-Free: 877.246.7900 (U.S. and Canada)
Tel: 949.452.1112 Fax: 949.452.1114
E-Mail: sales@biotechcatalog.com
Website: www.biotechcatalog.com