

How do I change a Membrane Cartridge on a 12 mm OxyProbe®?

STEP 1

While holding the membrane cartridge upright (with opening up) in one hand, carefully pour the electrolyte solution from the bottle into the cartridge until level is approximately 1/8" (3 mm) from the top edge of the cartridge. Remove any entrapped air bubbles by gently tapping on the side of the membrane cartridge sleeve. Try not to spill any of the electrolyte solution and be certain to wipe off any excess electrolyte from the outside surface of the cartridge sleeve with a clean tissue.

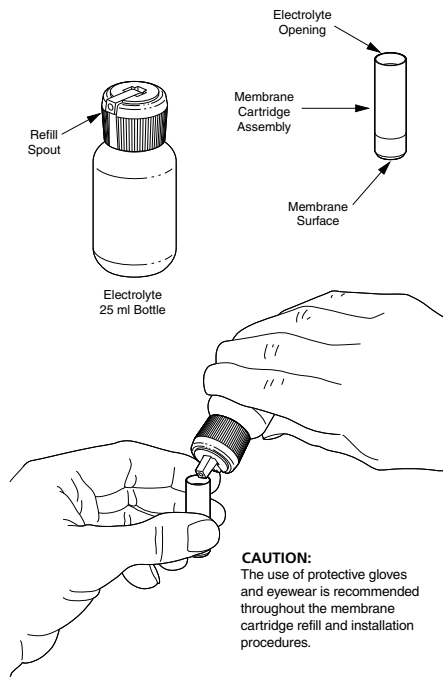

CAUTION:
The use of protective gloves and eyewear is recommended throughout the membrane cartridge refill and installation procedures.

STEP 2

In one hand, grip the membrane cartridge, which has been properly filled with electrolyte solution, by the thumb and fingers while holding the sensor assembly with the other hand as shown.

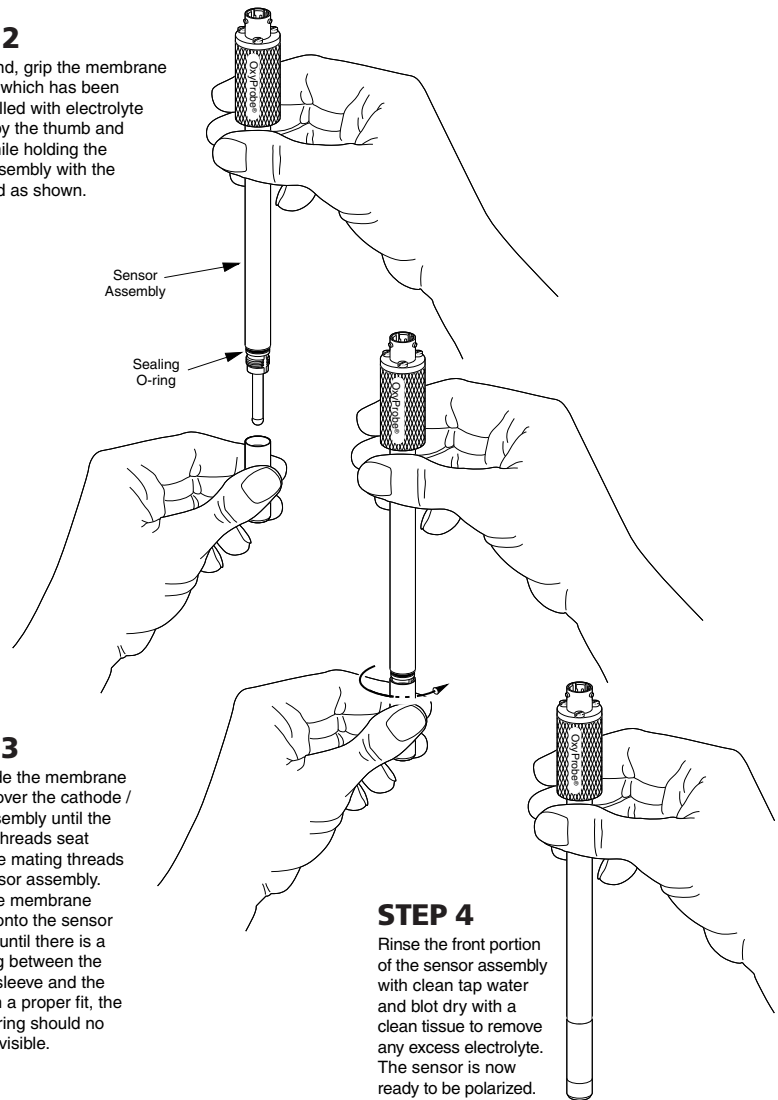

STEP 3

Gently slide the membrane cartridge over the cathode / anode assembly until the cartridge threads seat against the mating threads of the sensor assembly. Thread the membrane cartridge onto the sensor assembly until there is a flush fitting between the cartridge sleeve and the tube. With a proper fit, the sealing o-ring should no longer be visible.

STEP 4

Rinse the front portion of the sensor assembly with clean tap water and blot dry with a clean tissue to remove any excess electrolyte. The sensor is now ready to be polarized.

Note: Carefully inspect o-rings for any physical damage or excessive wear. Replace as needed or if there is any doubt as to their condition.

Measurement and Control Products for Science and Industry

19 Thomas, Irvine, California 92618 USA

Phone: (949) 829-5555 Toll-Free: (800) 288-2833 Fax: (949) 829-5560

E-Mail: sales@broadleyjames.com Website: www.broadleyjames.com

**BROADLEY
JAMES
CORPORATION**